

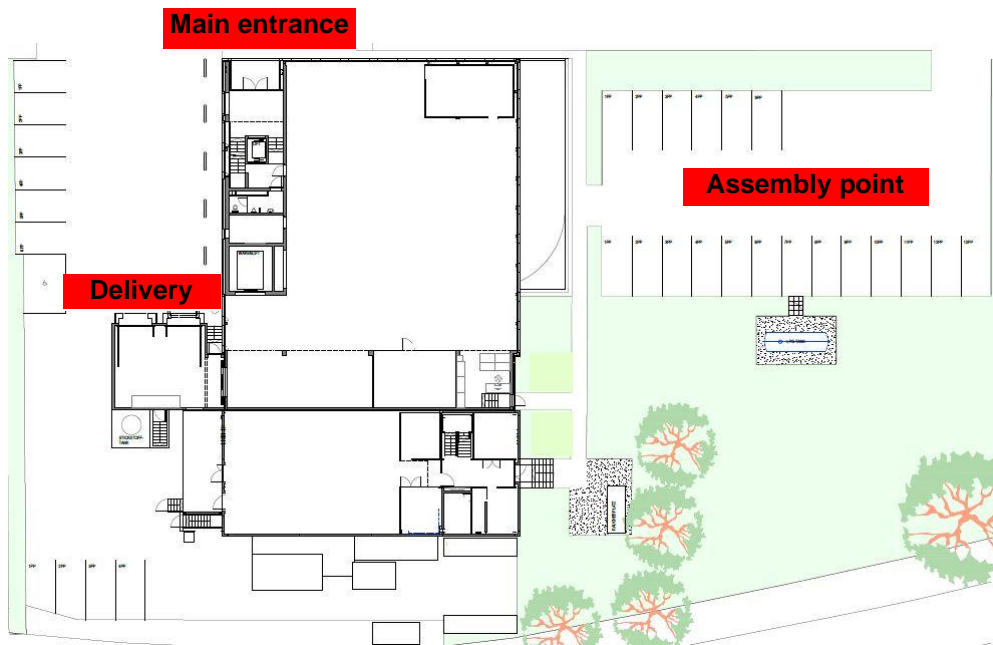

## Site Map



## Welcome



## Safety Instructions for Visitors and External Workers

Read the following safety instructions carefully

## GENERAL SAFETY INSTRUCTIONS

1. If possible, park in the visitor parking lot. Register at reception on the 3rd floor.
2. Contact your Givaudan representative before starting work.
3. External workers must visibly wear a visitor ID badge while on site.
4. Do not enter production, warehouse, or laboratories without permission. Working alone is not permitted.
5. Photography and video recordings are not permitted.
6. **Smoking is only permitted in the smoking area in the garden.**
7. Keep your workplace safe, clean, and tidy and work in accordance with the applicable SUVA rules.
8. Take any waste you bring into the site. Disposal at the site only if authorized by Givaudan personnel.
9. Eating and drinking is permitted in the break room on the 3rd floor, or in the garden seating area.
10. At the end of your visit, the work must be approved. Missing or unfinished tasks must be reported.



### Follow the instructions and requirements for protective equipment:

- Wear safety glasses.
- Wear safety shoes (cat. S2/S3).
- Wear clean work clothes (long pants mandatory).
- Wear helmet in the Actives Shed.



## HIGH RISK ACTIVITIES

### The site works with flammable liquids (ATEX zones)

Working in ATEX zones, in confined spaces, at heights, carrying out hot work and the use of hazardous substances is only permitted with written permission. Please contact your Givaudan contact person.



## IN CASE OF A FIRE ALARM

- Secure the workplace.
- Leave the building calmly along the escape routes.
- Go to the assembly point as marked on the site map (page 4).
- Wait for instructions from the assembly point manager.



## IN CASE OF A FIRE

- Trigger the alarm by pressing the fire alarm button and informing your contact person.
- Inform other people in the danger zone.
- Leave the building calmly along the escape routes.
- Go to the assembly point as marked on the site map (page 4).
- Wait for instructions from the assembly point manager.



## IN CASE OF AN ACCIDENT

- Injuries during work must be reported to us.
- For first aid, call the company paramedics (+41-44-908-4444).

